

brandstand
products[™]

cöbiemini

User Manual

Introduction

Thank you for purchasing the Brandstand CubieMini. This product allows the hotel to offer more outlets and USB charging to their guests at the desk level. Please be sure to read this User Manual carefully to ensure proper installation.

The information in this document is subject to change and does not represent a commitment on the part of Brandstand Products. No part of this document may be reproduced, transmitted in any form or by any means, electronic or mechanical, including photocopying, recording, or information storage and retrieval systems, or translated into any language for any purpose other than the purchaser's personal use, without the written permission of Brandstand Products.

Product Features

- Convenient connections for AC and USB-powered devices
- Efficient and stylish design with multiple mounting options
- Complete surge protection through all AC outlets and/or USB Ports

Product Description

- 2 AC outlets
- 2 Powered USB ports
- 2 Faceplate Color Options
- Surge Protector
- 6ft 15A Power Cord
- Adhesive Mounting Pad
- C Clamp
- 2 Wood Screws (included)
- Optional Mounting Kit

Quick Installation Guide

Installation Option #1:

1. Attach adhesive mounting pad (included) to bottom of the CubieMini.



2. Remove the adhesive covering and position CubieMini in the desired location.



3. To attach C Clamp - drill pilot holes at the desired screw location. A 1/16" or 3/32" drill bit should be used to reduce the risk of splitting the wood. Install wood screws (included) through C-Clamp and into the pilot holes.

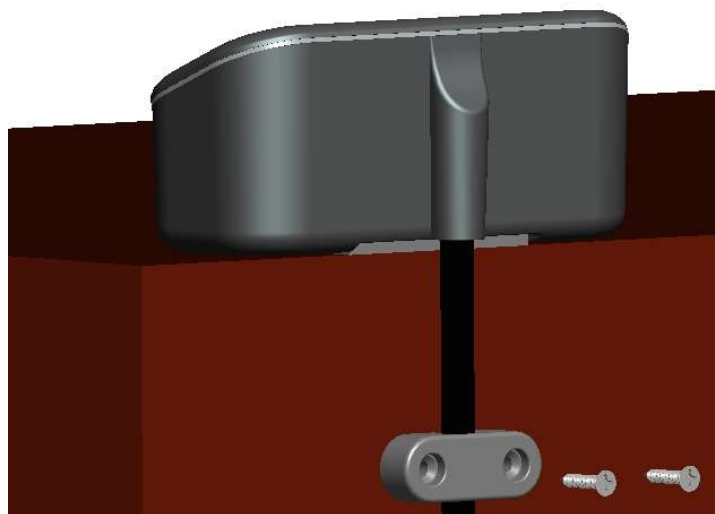

4. Plug directly into wall AC outlet. Do not plug into another surge protector or extension cord.

Installation Option #2:

For use with Optional Bracket Kit (purchased separately)

1. Attach bracket to the bottom of the CubieMini with 2 small machine screws (included)



2. Position CubieMini on the back of the desk. Drill pilot holes at the desired screw location. A 1/16" or 3/32" drill bit should be used to reduce the risk of splitting the wood. Install wood screws (included) through bracket and into the pilot holes.

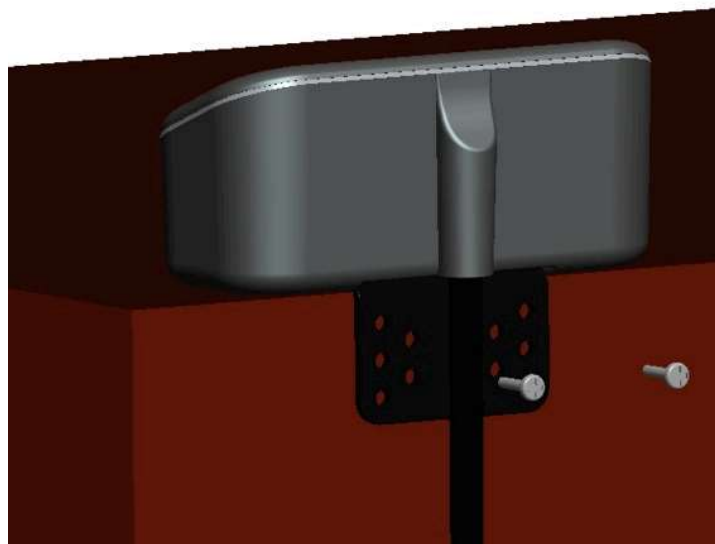

3. Plug directly into wall AC outlet. Do not plug into another surge protector or extension cord.

Technical Specifications:
Continuous Duty Electrical Rating
125VAC 12A 60Hz 1500W

150kHz-1000MHz up to 40db

Surge Response Time (ns)
<20 ns

Maximum Energy Dissipation
900J L-N 300J L-G 300J N-G
300J

Maximum Spike Current
36000A L-N 12000A L-G
12000A N-G 12000A

UL Clamping Voltage (3-line)
UL1449 800V

Working Temperature
-40°C – 80°C

AC Outlets Output
125V 12A

Power Cord
6ft 15W 3-line

Powered USB Output (Type A
Only)
5V/2100mA shared

Housing Material
UL94V-0

EMI/RFI Filtration (Type A Only)

Working Surroundings
Indoor Fixed Mount

Important Safeguards

- CAUTION – Do not install this device if there is not at least 10 meters (30 feet) or more of wire between the electrical outlet and the electrical service panel.
- Ensure that the unit is plugged into an AC120V~60Hz outlet. The use of incorrect outlets could cause the unit to malfunction or catch fire.
- To reduce the risk of fire or electrical shock, do not use this device with a receptacle in which the slot openings do not align with the blades.
- Do not allow children to operate the unit without adult supervision.
- Always ensure the product is unplugged from the electrical outlet before relocating or cleaning it.

- Keep the power cord and product away from heated surfaces.
- The unit should not be exposed to dripping or splashing and no objects filled with liquids, such as vases, should be placed on or around the product.
- Do not place or drop product into water or other liquids. If product falls into water, immediately unplug it from the electrical outlet; do not pull on power cord.
- Do not put any stress on the power cord where it connects to the product as the power cord could fray and break.
- Do not plug/unplug the product into/from the electrical outlet with a wet hand.
- Do not operate the product if it has a damaged or cut power cord or adapter, if wires are exposed, if it malfunctions, if it is dropped or damaged, or if it is dropped in or exposed to water.
- Place the unit where there is good air circulation.
- This product has no user-serviceable parts. Do not attempt to examine or repair this product yourself. Only qualified service personnel should perform the servicing; take the product to an electrical repair shop of your choice for inspection and repair.
- No open flame sources, such as candles, should be placed on the product.
- Product should only be used indoors and in dry locations. It should not be used with aquariums or other water-related products.